

# DC Block

# WA8039

10 MHz – 18.0 GHz

200 VOLTS

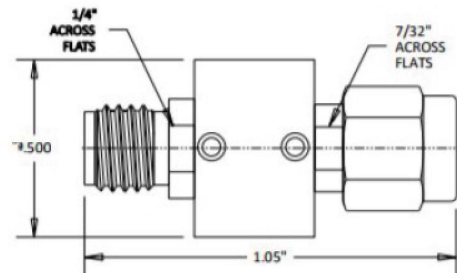

## Features

SMA stainless steel M/F connectors per MIL-STD-348A, interface dimensions mate nondestructively with MIL-PRF-39012. Designed to meet MIL-DTL-3933 environmental specification.

Inner/Outer DC Block combined with high frequency response. Bi-directional.

## Specifications

**Nominal Impedance:** 50 ohms.

**Frequency Range:** 10 MHz - 18.0 GHz.

**Voltage:** 200 volts

**Temperature Range:** -55°C to +105°C.

**Construction:** Passivated stainless steel connectors, PEEK body. Gold plated beryllium copper contacts. RoHS Compliant.

**Maximum VSWR:** 1.35

**Maximum Insertion Loss:** 0.5 dB

### Dimensions:

Length: 38.1 (1.05)  
Diameter: 12.7 (0.50)  
Weight: 0.004 (0.14)

*Note: Dimensions are given in mm (in), or kg (oz). Weight figure is nominal, with our standard connector configuration. Additional connector options may be available.*